

# BROWN COUNTY, SO. DAK.

HIGHWAY MAP

711

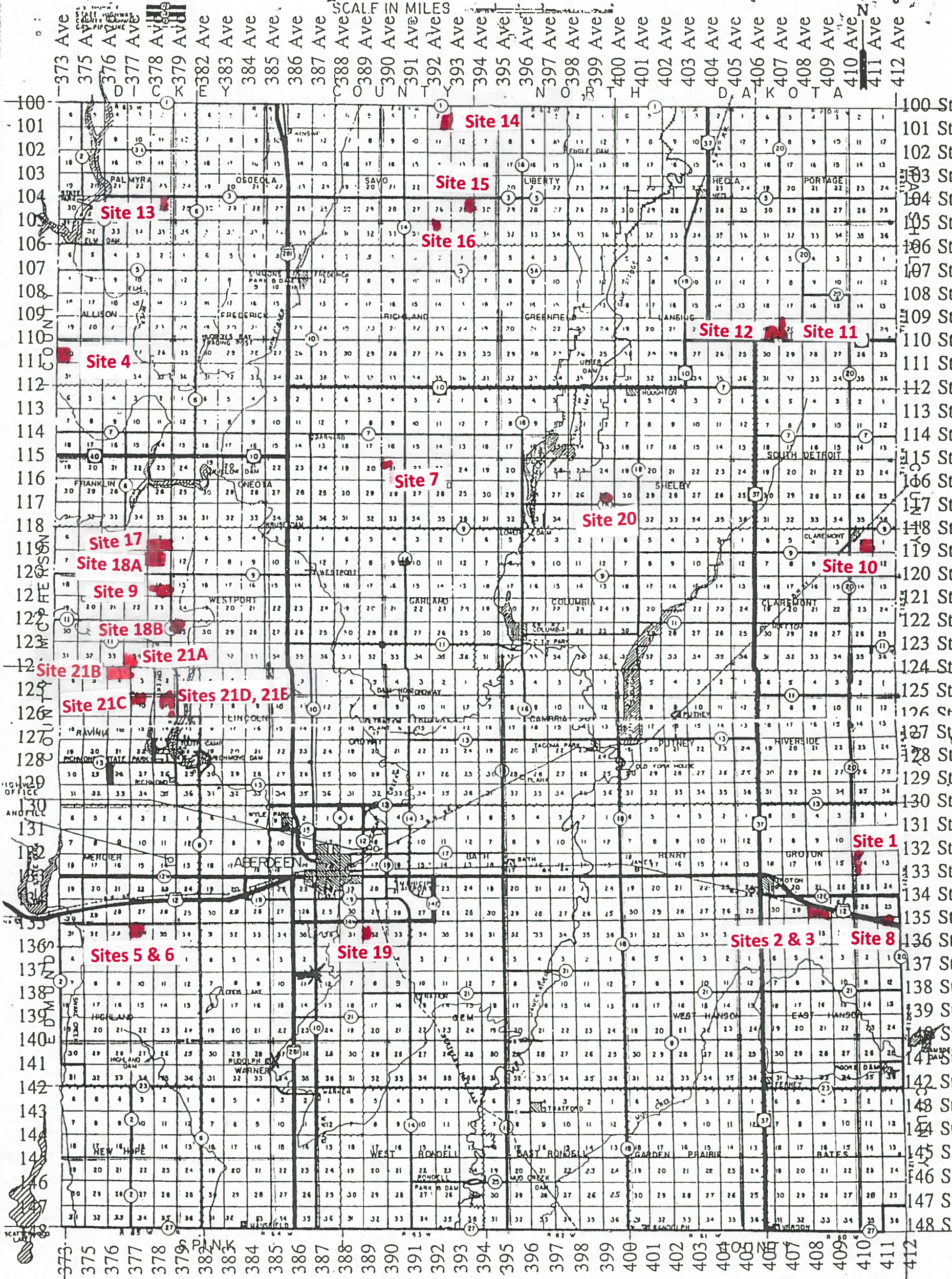

## Rural Named Roads

- |                       |   |                     |  |
|-----------------------|---|---------------------|--|
| Buick Dr              | West off 387 Ave, .8 mile south of 135 St                   | Nash Rd             | North out of Mansfield                                       |
| Cadillac Dr           | West off 387 Ave, 1 mile south of 135 St                    | Park Rd             | Between 132 & 134 St, .5 mile east of 395 Ave                |
| Camino Real           | North off 130 St, .5 mile west of 388 Ave                   | Pleasant Valley     | North off 129 St, .6 mile east of 382 Ave                    |
| Chevy Ct              | North - South, between Cadillac Dr & Dodge Dr               | Pontiac Dr          | Between Cadillac Dr & Dodge Dr                               |
| Country Pl            | East - West, off Country Dr                                 | Prairie St          | West off 395 Ave, .7 mile south of 132 St                    |
| Country Dr - Aberdeen | South off 129 St, .3 mile west of 386 Ave                   | Putney Rd           | North - South, .5 mile east of 402 Ave - to Putney           |
| Country Dr - Bath     | West off 395 Ave, .8 mile south of 132 St                   | Railroad Rd         | South out of Hecla   |
| Dodge Dr              | West off 387 Ave, .5 mile south of 136 St                   | Richmond Heights Dr | North off 130 St, .6 east of 383 Ave                         |
| Fairfield Dr -        | North off 129 St, .1 mile west of 386 Ave (Fischer Estates) | Richmond Heights Dr | West off 384 Ave, .8 mile south of 129 St                    |
| Fairfield Dr          | East off 386 Ave, .5 mile south of 128 St (Fischer Estates) | Rotelle Rd          | .5 mile east of 394 Ave between 121 & 122 St                 |
| Ford Pl               | South, off Dodge Dr   | Sand Lake Dr        | East off 396 Ave into Sand Lake Refuge                       |
| Freudenthal Rd        | West off 403 Ave, Between 101 & 102 St                      | Yorkville Rd        | North off 129 St & west off 401 Ave, on the 1/2 mile lines   |
| Hobby Dr              | North off 128 St, .6 mile west of 388 Ave                   | Youth Camp Rd       | West off 382 Ave, south of 127 St into the Youth Camp & GF&I |
| Hobby Dr              | West off 389 Ave, .6 mile south of 127 St                   |                     | Richmond Lake  |
| James Rd              | East off 400 Ave, .5 mile south of 132 St to James          |                     |  |